

**Robinet cu sertar cauciucat,
cu socket**
**Soft wedge gate valve
with pipe socket**
**Weichkeilschieber
mit Rohrmuffe**

Date tehnice:		Technical data:		Technischedaten:	
lungime de constructie	conform desen	fitting length	acc. to drawing	Bebaungslänge	nach Zeichnung
Presiune maxima de lucru Clasa de etansare - A	PN 16	Working pressure max. Leakproofness class - A	PN 16	Arbeitsdruck max. Dichtheitsklasse - A	PN 16
Temperatura maxima de lucru	70°C (120°C)	Working temperature max.	70°C (120°C)	Arbeittemperatur max.	70°C (120°C)
Caracteristici de constructie:		Design features:		Baucharakteristik:	
<p>Inelele de etansare ale tijeii (O-ring) pot fi schimbate fara a scoate robinetul din instalatie. Tija robinetului este din otel inoxidabil. Sertarul este acoperit in totalitate cu cauciuc, iar piulita tijeii poate fi inlocuita.</p> <p>Toate partile componente sunt protejate impotriva corozionii. Executie standard : PN16, 70°C, EPDM, vopsea epoxidica RAL5005 250 µm.</p> <p>Aviz sanitar emis de PZH</p>		<p>O-ring spindle's gaskets - "DRY THREAD" - replaceable under pressure. Stainless steel bearing spindle with rolling thread. Total sufrage rubbered wedge with replaceable spindle nut.</p> <p>All parts are protected against corrosion</p> <p>Standard execution: PN16, 70°C, EPDM, epoxide paint RAL5005 250 µm.</p> <p>Hygenic atest by PZH</p>		<p>O-Ring Spindeldichtung - "Trocken Gewinde" - mit Unterdruckwechselfähigkeit gemacht. Niro-Stahl lagere Spindel mit Walzengewinde. Keil mit Gummi ganz bedekt und auswechselbar Spindelmutter.</p> <p>Alle Teile sind gegen Korrosion schützen</p> <p>Standardausführung: PN16, 70°C, EPDM, Epoxyemalie RAL5005 250 µm.</p> <p>Hygienische Attest PZH</p>	
Domenii de utilizare:		Application:		Anwendung:	
In instalatii de apa, apa potabila si alte fluide		In instalations for water and other inert fluids to flow closing.		In Wasserlinien und andere neutrale Flüssigkeitenlinien zu Fluß verriegeln	
Montaj:		Assembly:		Aufstellung:	
Montajul se face in pozitie orizontala sau verticala.		Assembly in optional position.		Aufstellung im beliebig Position.	

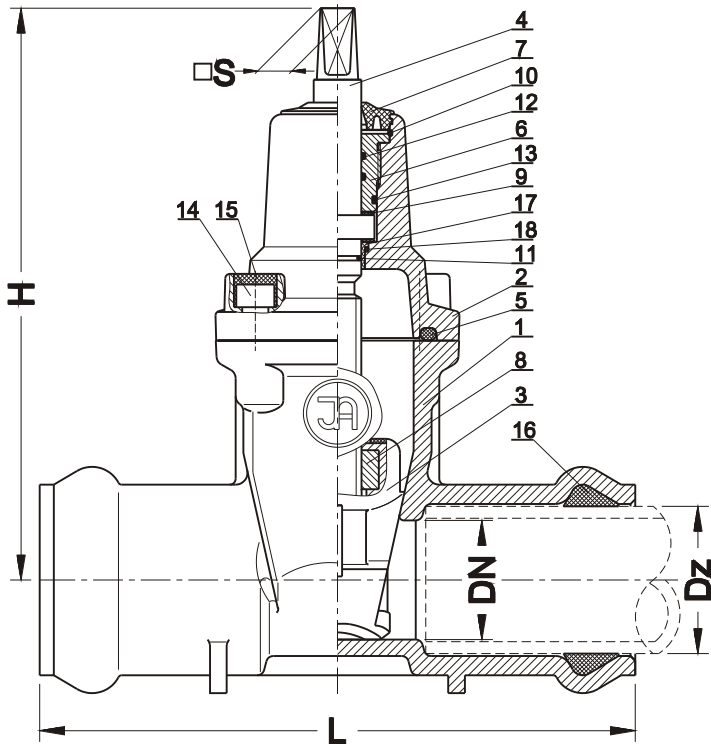

No.	Reper, Part, Teil	Material
1	Corp, Body, Gehäuse	EN-GJL-250, SR-EN 1561:2000 EN-GJS-400-15, SR-EN-1563:2000 GG25 - DIN 1691, GGG40 - DIN 1693
2	Capac, Bonnet, Deckel	EN-GJL-250, SR-EN 1561:2000 EN-GJS-400-15, SR-EN-1563:2000 GG25 - DIN 1691, GGG40 - DIN 1693
3	Sertar, Wedge, Keil	EN-GJL-250, SR-EN 1561:2000 EN-GJS-400-15, SR-EN-1563:2000 GG25 - DIN 1691, GGG40 - DIN 1693 EPDM/ NBR
4	Tija, Spindle, Spindel	Otel inox X20Cr13 SR-EN 10088-1:1998 Steel, Stahl DIN 1.4021
5	Garnitura corp-capac, Bonnet gasket , Dichtung	Cauciuc, Rubber, Gummi EPDM/NBR
6	Bucsa tija, Packing cork, Dichtungkork	Aliaj cupru SR-EN 1982:2002, brass, Messing DIN 17660
7	Garnitura antipraf, Clean gasket, Putzendichtung	Cauciuc, Rubber, Gummi EPDM/NBR
8	Piulita tijeii, Spindle nut, Spindelmutter	Aliaj cupru SR-EN 1982:2002, brass, Messing DIN 17660
9	Saiba tija, Spindle washer, Spindelscheibe	Teflon (Tarflon)
10	Inel opritor, Stopper ring, Sicherungring	Otel, Steel, Stahl 65G
11-13	Inel etansare, Seal O-Ring , Dicht-O-Ring	Guma, Rubber, Gummi EPDM/NBR
14	Organe asamblare , Screw , Schraube	Otel Fe/Zn5, otel zincat SR-EN ISO 4762:2001
15	Protectie organe asamblare, Screw stopper, Garnitura,	Parafina Paraffin
16	Gasket , Dichtung	Cauciuc, Rubber, Gummi EPDM, NBR
17	Saiba tija, Spindle sleeve, Spindelhulse	Teflon (Tarflon)
18	Inel etansare (O-ring), Seal O-Ring, Dicht-O-Ring	Cauciuc, Rubber, Gummi EPDM/NBR

DN	D ₂	L	H	□ S	Masa	
					[mm]	[kg]
50	63	250	240	14	8,2	
80	90	280	307	17	14,3	
100	110	300	349	19	22,3	
150	160	350	475	19	38,1	
200	225	400	534	24	67,5	