

Robinet cu sertar cutit

Knife gate valve

Messerkeilschieber

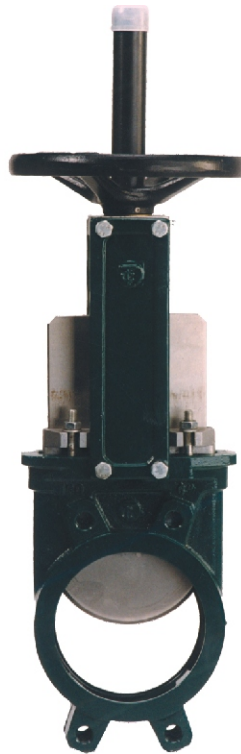

Date tehnice:	Technical data:	Technische Daten:
<p>Presiuni maxime de lucru: DN50 - 250 PN 10 DN300 - 450 PN 7 DN500 - 600 PN 4 DN700 PN 2 Temperatura maxima de lucru: NBR 80 C, EPDM 110 C</p> <p>Executie: Tija ascendenta sau neascendenta</p>	<p>Maximum working pressures: DN50 - 250 PN 10 DN300 - 450 PN 7 DN500 - 600 PN 4 DN700 PN 2 Maximum working temperatures: NBR 80 C, EPDM 110 C</p> <p>Execution: Rising or non-rising spindle</p>	<p>Maximum Arbeitdrück: DN50 - 250 PN 10 DN300 - 450 PN 7 DN500 - 600 PN 4 DN700 PN 2 Maximum Arbeittemperatur: NBR 80 C, EPDM 110 C</p> <p>Ausführung: Erheben oder Nicht-Erheben Spindel</p>
Materiale:	Materials:	Materialen:
<p>Corp fonta cenusie GG25 Sertar otel inoxidabil 304 Tija otel inoxidabil Garnitura NBR Vopsire: Vopsea epoxidica, cu grosimea de 200µm, culoare verde</p>	<p>Body gray cast iron GG25 Disc stainless steel 304 Stem - stainless steel Gasket NBR Paint: epoxide paint of 200 microns thickness, green color</p>	<p>Gehäuse Grauguß GG25 Disk Niro-Stahl 304 Spindel - Niro-Stahl Dichtung NBR Bedeckung: Epoxyemalie; Schichtdicke 200µm, grüne Farbe</p>
Domenii de utilizare:	Application:	Anwendung:
<p>Pentru medii fluide sau pulberi, - statii de tratare a apei - apa potabila, ape uzate - industria chimica - fabrici de celuloza si hartie</p>	<p>For fluid and powder medium - water treatment - potable water, waste water - chemical industry - pulp industry</p>	<p>Für fluid und locker Medium - Abwasser - Trinkwasser, Industrialwasser - Chemischeindustriellen - Papierindustriellen</p>
Montaj:	Assembly:	Aufstellung:
<p>Robinetul poate fi montat in orice pozitie, dar este recomandat sa fie montat in pozitie orizontala sau verticala</p>	<p>The valve can be assembled in any position however, we recommended vertical and horizontal position</p>	<p>Aufstellung im beliebig Position. Aber Wir empfehlen verticale und horizontale Position</p>

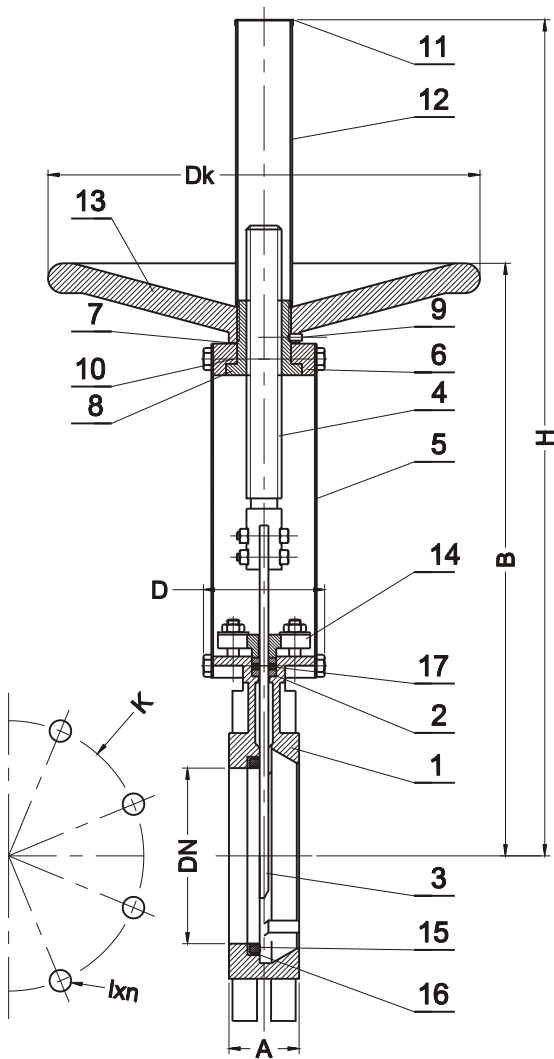

No.	Reper	Material
1	Corp, Body	fonta cenusie EN-GJL-250 SR-EN 1561:2000 otel inoxidabil
2	Inel etansare, Gland seal,	Snur textil
3	Cutit, Knife	Otel inoxidabil X6CrNiTi8-10
4	Tija, Spindle	Otel inoxidabil X20Cr13
5	Teava, Tube	Otel 12X Fonta ductila EN-GJS-400-15 SR-EN 1563:2000
6	Suport piulita, Nut support	Otel 12X
7	Garnitura, Washer	Cauciuc EPDM/NBR
8	Piulita tijeii, Spindle nut	Aliaj cupru
9	Organe asamblare, Set screw	Otel
10	Gresor, Greaser	Otel inoxidabil
11	Capac protectie, Cap	Polipropilena
12	Teava protectie, Protective tube	Otel R45
13	Roata manevra, Hand wheel	fonta cenusie EN-GJL-250 Sr-EN 1561:2000
14	Saiba, Clamping plate	Silumin AlSi
15	Garnitura, Gasket	Cauciuc EPDM/NBR
16	Inel opritor, Stopper ring	Otel inoxidabil X6CrNiTi8-10
17	Inel etansare (O-Ring), Seal O-Ring	Cauciuc EPDM/NBR

DN	Tip mecanism de actionare	Flansa cuplare mecanism actionare	Filet	DN	K	I x n	A	B	D	H	Dk	Masa Weight
[mm]			[mm]	[mm]								[kg]
50	SA 07.1 (F7)	F7	Tr 20x4 LH	50	125	18x4	40	283	83	348	200	8
65				145	18x4	308		10				
80				160	18x8	333	11					
100				180	18x8	378	12					
125	SA 07.5 (F7/F10)	F7/F10	Tr 25x5 LH	125	210	18x8	50	423	93	564	250	17
150				240	22x8	474		21				
200				295	22x8	593	38					
250				350	22x12	685	52					
250	SA 10.1 (F10)	F10	Tr 35x6 LH	250	350	22x12	70	792	108	946	310	52
300				400	22x12	1118		63				
350				460	22x16	96	900	1282				115
400				515	28x16	100	978	1441				145
450	SA 14.1 (F14)	F14	Tr 35x6 LH	450	565	28x20	106	1105	290	1587	500	186
500				620	28x20	1215		221				
600				725	31x20	110	1418	2060				265
700				840	31x20	1640	400	2372				800